

Please go to the below link and download the latest version install using all the defaults.

<https://www.citrix.com/downloads/workspace-app/windows/workspace-app-for-windows-latest.html>

Download the latest version and install using the defaults.

After install please close all browsers and reopen.

Open this link to log into Citrix: <https://citrix.ttx.com/vpn/index.html>

Connect with your TTX Credentials and through Duo 2FA and Select the Detect Receiver

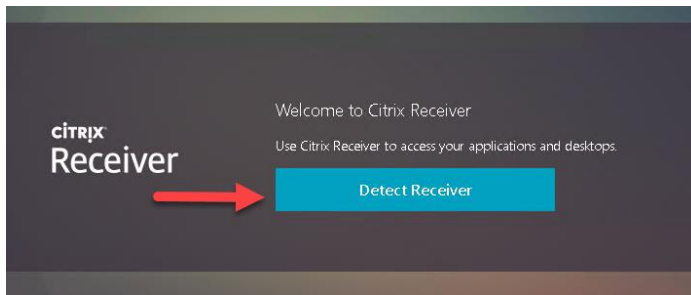

Select always allow and then open Citrix workspace Launcher. (Please note that after this a black screen will appear, depending on your connection speed it may take 1-2 min to load.)

